



PROJECT		REF		REV	ITEM CODE	
LOCATION		DATE			PAGE	

SANITARY WARE SPECIFICATION SHEET

Item Descriptions	GROHE (Germany) "Atrio" Lever-handles three-hole M-size basin mixer 1/2" with chrome plated finish; nominated flow rate 5.3 L/min in WELS Grade 2; Registration No. TM 20-0146
Model	20009003
Finish / Material	Chrome Plated
Country of origin	Germany
Manufacturer	GROHE Limited
Supplier	Acme Sanitary Ware Co. Ltd Mr. Eric Wong/ Mr. Don Yuen
Contact Tel/Fax	(852) 2388-7171 / (852) 2710-8012
E-mail	acme@acmesanitary.com.hk
Website	www.acmesanitary.com.hk

Illustration/ Drawing

"Atrio"
Lever-handles three-hole M-size basin mixer 1/2"

- ceramic headparts 1/2", 90°
- GROHE StarLight** chrome finish
- GROHE EcoJoy** 5.7 l/min laminar mousseur
- swivel tubular spout with mousseur and stop limiter
- pop-up waste set 1 1/4"
- flexible connection hoses between spout and side valves
- with lever handles
- Two different sets of caps included. One set with "H" and "C" marking, one set without marking

GROHE
ATRIO

THE ICON OF ELEGANCE AND PRECISION

Consider the circle. A staple of natural geometry. A pure form at once soothing and dynamic. A visual metaphor for both, completeness and eternity. For its Atrio collection GROHE draws on this most elemental and elegant form to create an iconic object that is built to last.

The Atrio collection means design without restrictions. Each item is available in various finishes and size options to meet all demands of personal taste and different design schemes.

Colour options:

● 003 StarLight Chrome	● GL3 Cool Sunrise
● DC3 SuperSteel	● GN3 Brushed Cool Sunrise
● DA3 Warm Sunset	● DL3 Brushed Warm Sunset
● A03 Hard Graphite	● BE3 Polished Nickel
● AL3 Brushed Hard Graphite	● EN3 Brushed Nickel

20009DC3
20009DA3
20009GL3
20009AL3

Note: [YouTube \(GROHE Atrio Product\) https://www.youtube.com/watch?v=HJDtY_EFMdM](https://www.youtube.com/watch?v=HJDtY_EFMdM)

* All information of the above is for the reference only. No prior notice is made if any changes.



PROJECT		REF		REV	ITEM CODE	
LOCATION		DATE			PAGE	

SANITARY WARE SPECIFICATION SHEET

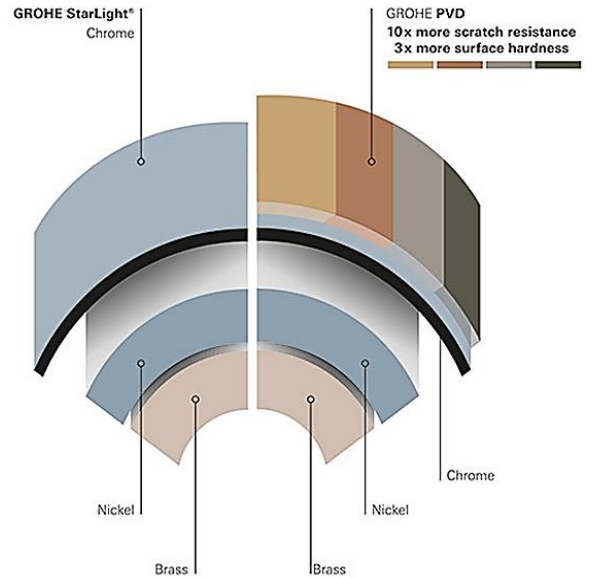
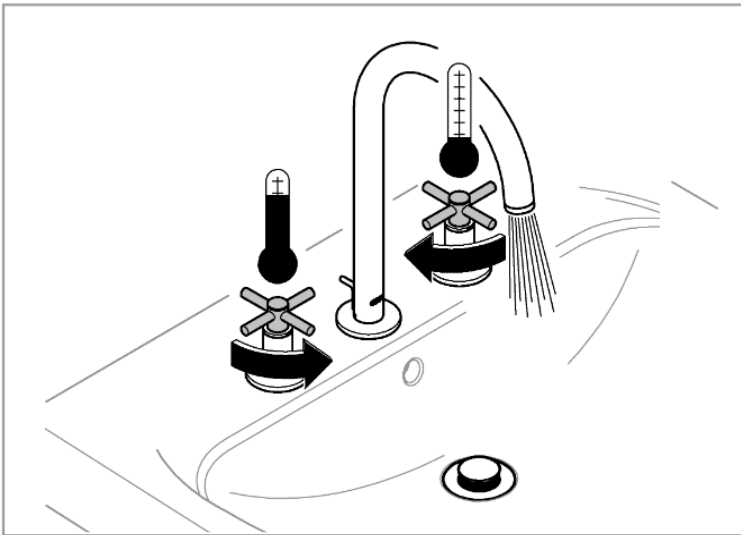

SPARE PARTS

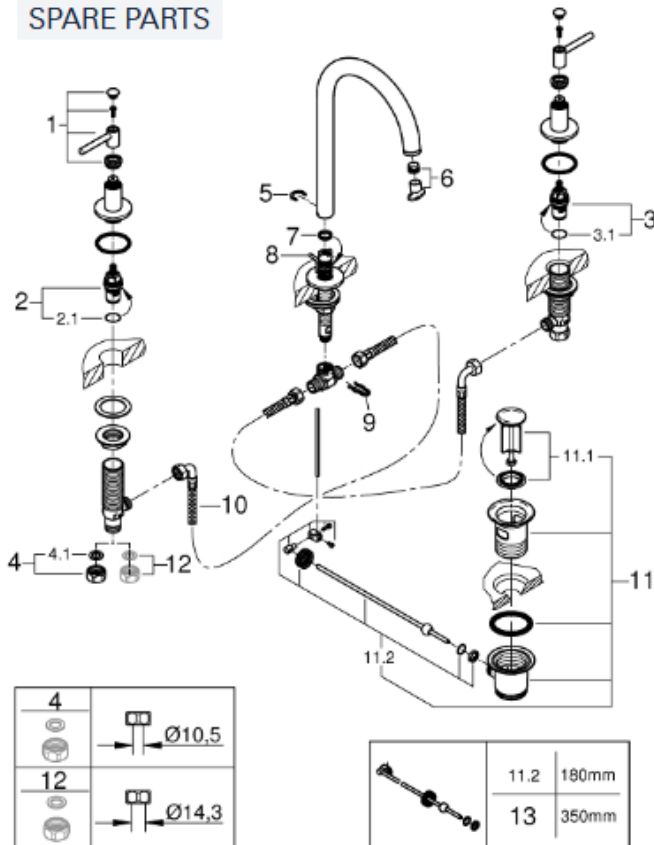

Pos.-nr.	Prod. description	Order-nr.
1	Lever handles	18027003
2	Ceramic headpart 1/2"	45882000
2.1	O-ring Ø 18.2 x Ø 1.7	0392400M
3	Ceramic headpart 1/2"	45883000
3.1	O-ring Ø 18.2 x Ø 1.7	0392400M
4	Coupling nut 1/2"	1290100M
4.1	Fibre seal Ø 18,5 x Ø 12 x 2	0138900M
5	Safety ring	4826600M
6	Laminar flow straightener	48408000
7	Sealing washer Ø 13.5 x Ø 2.75	0128500M
8	Pop-up rod	65196000
9	Fixing clamp	6554100M
10	Flexible connection hose	45704000
11	Waste set 1 1/4"	28910000
11.1	Plug for waste set 1 1/4"	07182000
11.2	Eccentric rod	07052000
12	Coupling nut 1/2" x 14.5 mm	1290200M*
13	Eccentric rod	07341000*

* Optional accessories

Note:

* All information of the above is for the reference only. No prior notice is made if any changes.

註冊號碼 (Registration No.): TM 20-0146



自願參與用水效益標籤計劃 - 水龍頭
Voluntary Water Efficiency Labelling Scheme - Water Taps



茲證明
This is to certify that

將下列水龍頭在本計劃內註冊：
has registered the following water tap under this scheme :

- 牌子 / Brand : Grohe
- 型號 / Model : 20009XX3 + 410992031
- 種類 / Type : Mixing
- 原產地 / Country or Region Origin : Germany (Mixer & Flow Controller)

XX – denotes colour variants

在用水效益標籤上展示的標誌 <i>Symbolic Presentation on the Water Efficiency Label</i>	: 	滴水點 <i>Water droplet(s)</i>
用水效益級別 <i>Water Efficiency Grade</i>	: 2	
耗水量 <i>Water Consumption</i>	: 5.3	公升/分鐘 <i>litres/minute</i>

簽發日期：
Date of Issue: 4 September 2020



水務署署長(葉哲奇代行)
for Director of Water Supplies



水務署
Water Supplies Department

總部 Headquarters

香港灣仔告士打道七號入境事務大樓 48 樓

7 Gloucester Road, Wan Chai, Hong Kong



本署檔
Our ref.
來函檔號
Your ref.

1/18 Pt.1 T/J(1342)

電話 :
Tel :
傳真 : 2824 0578
Fax :

9 January 2019



**Approval of "GROHE" Basin Mixer
(General Acceptance No. C20190033)**

Your letter ref. WRC/2014 dated 4 December 2018 refers.

Having considered the test report ref. J23598A issued on 28 November 2018 by Nutek Systems (HK) Ltd., this Authority accepts that the fitting described below complies with, and its use when correctly installed does not contravene, the Waterworks Ordinance and Regulations.

Name of Manufacturer: Grohe AG

Country of Origin: Germany

Brand: Grohe

Details of Fitting: 1/2" 3-hole basin mixer supplied with one pair of stainless steel wire braided water inlet flexible hose (manufactured by Neoperl GmbH, Model: Neoflex SPX DN6 G3/8") approved by UK's WRAS under ref. 1506306

Model: 20009XX3
(where the digits "XX" denote the code of colour)



Body Markings:



Expiry Date:

11 November 2023 (for mixer)
30 June 2020 (for hose)

This Authority hereby permits the use of the above fitting in fresh water plumbing systems subject to full adherence to Waterworks installation requirements. In particular, you are required to draw your customers' attention to the following requirement-

“The cold water supply to the fitting shall be drawn from the same source that supplies the hot water apparatus so as to provide a balanced pressure and to obviate the risk of scalding in the event of a restriction or failure in the water supply.”

A condition of this acceptance is that the fitting to be installed shall be replicas of the sample as certified by the testing agent mentioned above and without modifications. This acceptance may be withdrawn at any time if the standard of the fitting installed fails to meet that of the approved sample or if the fitting is found to be unsuitable for use in fresh water plumbing systems.

This acceptance is only applicable to the main body of the fitting, unless other specified.

For the use of the fitting in any project, the General Acceptance Number of this letter must be quoted as a means of identification of acceptance of the fitting by this Authority.

Should you have any enquiries, please contact our Engineer Mr. Terry KUNG at tel. no. 3583 4086.

Yours faithfully,

(CHAN Chung-kun)

for Director of Water Supplies

Encl.

c.c. WSD 3321/1/82] - without catalogue
ME/MC] - with soft copy only